



local exhausts – table with extraction – **SLOT**



Application

A table with extraction SLOT has been developed to extract the air polluted with dry dust, emitted mainly during the welding processes, but also other operations as wood processing, grinding, metal trimming. Additionally, (after grate replacement) it can be applied for dust extraction during manual cutting with a plasma burner.

The contamination is being captured directly close to the source of emission: downwards – through the suction chamber with a grate surface and aside – through the side suction chamber. The table ought to be connected to the extraction fan, filtering unit or to the central collecting ductwork.

Structure

The self-supporting structure consists of a chamber with a grate top. On the chamber is located another chamber for side extraction. Each table is equipped with a connection of diameter adjusted to the volume flow. In the lower part of the device, there are drawers collecting the accumulated dust.

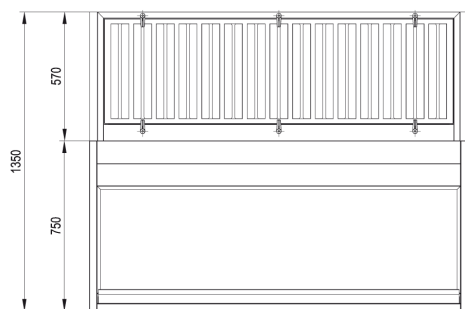

front view

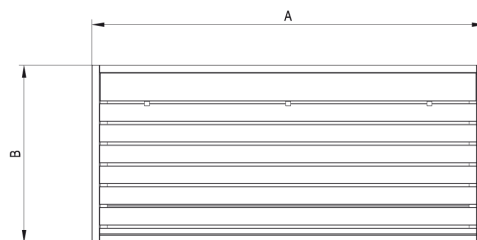

top view

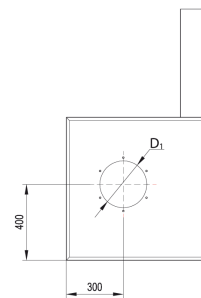

side view

Device type	Part.No	A	B	D ₁	Recommended volume flow (m ³ /h)	Weight [kg]
SLOT 1600	813S13	800	750	180	1600	68
SLOT 2000	813S14	1200	750	250	2000	98
SLOT 3000	813S15	1600	750	280	3000	128
SLOT 4000	813S16	2000	750	300	4000	160

Additional equipment

Replaceable grate

Device type	Part.No	Remarks
	R-1600	801R04
	R-2000	801R05
	R-3000	801R06
	R-4000	801R07
<p>Due to the grate, it is possible to apply the device for extraction while cutting with a manual plasma burner.</p> <p>The grate has to be installed in a place of the standard grate.</p>		